

# LICENSING ACT 2003

# Premises Licence

Schedule 12  
Part A (Regulation 33,34)  
HARROW COUNCIL, P O BOX 18, STATION ROAD, HARROW

Premises Licence Number: LN/000003641/2011/2

Part 1 – Premises details

Postal address of premises, or if none, ordnance survey map reference or description:

The Star Lounge Bar & Restaurant, 32 Railway Approach, Wealdstone, Harrow,  
Middlesex, HA3 5AA

Telephone Number: [REDACTED]

Where the licence is time limited, the dates:

N/A

Licensable activities authorised by the licence:

Live music (e), Recorded music (f), Performance of dances (g), Performance similar to e f g (h),  
Provision of facilities music (i), Provision of facilities dance (j), Provision of facilities similar i j  
(k), Late night refreshment (l), Sale of retail alcohol (m)

Signed by Finlay Flett  
Head of Community Safety Services



**Licensable Area  
Hours open to public**

Sunday	00:00 - 02:30	12:00 - 00:00
Monday	00:00 - 00:30	12:00 - 00:00
Tuesday	00:00 - 00:30	12:00 - 00:00
Wednesday	00:00 - 00:30	12:00 - 00:00
Thursday	00:00 - 00:30	12:00 - 00:00
Friday	00:00 - 00:30	12:00 - 00:00
Saturday	00:00 - 02:30	12:00 - 00:00

On commencement of British Summer Time one hour should be added to the finish time.  
From the end of the sale of alcohol on the 31st December until the start of the sales of alcohol on the following day

**The times the licence authorises the carrying out of licensable activities**

**Location: Licensable Area**

Live music (e), Recorded music (f), Performance of dances (g), Performance similar to e f g (h),  
Provision of facilities music (i), Provision of facilities dance (j), Provision of facilities similar i j (k),  
Sale of retail alcohol (m)

Sunday	00:00 - 02:00	12:00 - 00:00
Monday	-	12:00 - 00:00
Tuesday	-	12:00 - 00:00
Wednesday	-	12:00 - 00:00
Thursday	-	12:00 - 00:00
Friday	-	12:00 - 00:00
Saturday	00:00 - 02:00	12:00 - 00:00

On commencement of British Summer Time one hour should be added to the finish time.  
From the end of the sale of alcohol on the 31st December until the start of the sales of alcohol on the following day

**Location: Licensable Area**

**Late night refreshment (l)**

Sunday	00:00 - 02:00	23:00 - 00:00
Monday	-	23:00 - 00:00
Tuesday	-	23:00 - 00:00
Wednesday	-	23:00 - 00:00
Thursday	-	23:00 - 00:00
Friday	-	23:00 - 00:00
Saturday	00:00 - 02:00	23:00 - 00:00

On commencement of British Summer Time one hour should be added to the finish time.  
From the end of the sale of alcohol on the 31st December until the start of the sales of alcohol on the following day

Where the licence authorises supplies of alcohol – whether these are on and/or off supplies  
**Sale by retail on premises**

## Part 2

Name, (registered) address, telephone number and email (where relevant of holder of premises licence:

Star Spice Limited  
32 Railway Approach  
Harrow  
Middlesex  
HA3 5AA

Telephone: [REDACTED]  
Email: [REDACTED]

Registered number of holder, for example company number, charity number (where applicable):

**07332763**

Name, address and telephone number of designated premises supervisor where the premises licence authorises for the supply of alcohol:

**Ramesh Bhimji**

[REDACTED]

Personal licence number and issuing authority of personal licence held by designated premises supervisor – where the premises licence authorises for the supply of alcohol:

**HARROW - 09RB-00AQ-37JP-ERDJ**

State whether access to the premises by children is restricted or prohibited: **N/A**

## **Annex 1 – Mandatory Conditions**

Mandatory conditions where licence authorises supply of alcohol:

- 1 No supply of alcohol may be made under the premises licence -
  - a) at a time when there is no designated premises supervisor in respect of the premises licence, or
  - b) (b) at a time when the designated premises supervisor does not hold a personal licence or his personal licence is suspended
2. Every supply or sale of alcohol made under the premises licence must be made or authorised by a person who holds a personal licence.

Mandatory conditions where licence authorises exhibition of films:

- (1) The admission of persons under the age of 18 years to exhibitions of films must be restricted in accordance with any recommendation made by the British Board of Film Classification, except where condition 2 applies.
- (2) The admission of persons under the age of 18 years to exhibitions of films must be restricted in accordance with any recommendation made by the relevant licensing authority regarding the film in question

Mandatory condition where licence requires door supervision:

Where one or more individuals are required to be at the premises to carry out a security activity, such individual(s) must be licensed by the Security Industry Authority.

## **Annex 2 - Conditions consistent with the operating Schedule**

1. Staff are trained as appropriate in respect of relevant licensing law, the implementation of licence conditions, health safety, first aid, alcohol and drug awareness and conflict management.
2. Customers will not be permitted to take open glass containers outside the premises, as defined in the plan submitted with the operating schedule and approved by the Licensing Authority.
3. The consumption of alcohol will be restricted to those parts of the premises identified on the plan submitted with the operating schedule and approved by the Licensing Authority.
4. Notices will be displayed at each public entrance to the premises, which clearly state the premises policy on admission and searching.
5. Substantial food to be available until 23:30 hours.
6. The applicant monitors the need for door supervisors and in so doing takes into account any advice given by the Police.
  - i. SIA Door Supervisors shall be employed on any evening when the premises are open past midnight.
  - ii. A "Magic Wand" metal detector shall be kept, maintained and used on the premises.
  - iii. A register containing the full details of the Door Supervisors shall be kept on the premises and supplied to the Police or Local Authority on request.
7. The Metropolitan Police Service (MPS) must be given at least 14 days notice of all forthcoming events organized by an external promoter and have received a completed MPS Promotion / Event Risk Assessment (form 696) 14 days in advance of any such event. A copy of the form 696 is also to be provided to the Licensing Office at South Harrow Police Station.

The Metropolitan Police Service must have received a completed MPS Debrief Promotion / Event Risk Assessment (form 696a) three days after any risk assessed event.

8. The Pub Manager is required to actively participate in and support the local Pubwatch Scheme (where active)
9. In Line with our Alcohol and Social Responsibility Policy there will be no promotions that encourage illegal, irresponsible or immoderate consumption.
10. All incidents are logged and recorded in a log book.
11. There is an established procedure for the confiscation of drugs agreed with local police.
12. Known troublemakers are barred.
13. A security manual is available on site.
14. Toilets are checked an average of 2 hourly daily and a log kept of the times/dates they are visited.
15. The premises operate the current local authority or similar "proof of age" scheme and display the relevant literature.
16. CCTV shall be maintained and operated in good order and to the satisfaction of the Metropolitan Police Crime Prevention officer's reasonable request.
17. A monitored central station alarm and security system shall be maintained and operated in good order and to the satisfaction of the Metropolitan Police Crime Prevention Officer's reasonable request.
18. Free drinking water is available to customers.
19. Floor staff conduct physical sweeps inside the premises to remove hazardous objects/waste.
20. Phone number of an allocated taxi firm displayed on the premises.

21. The maximum number of persons accommodated on the premises at any one time should not exceed 280 (excluding staff)
22. Door supervisor and management monitor the behaviour of customers leaving the premises.
23. Notices to be displayed to encourage customers to leave the premises quietly.
24. Deliveries are conducted during daytime to control noise nuisance.
25. Doors and windows shall be kept shut during the provision of licensable activities, except for purposes of access and egress.
26. Noise or vibration shall not be permitted to emanate from the premises so as to cause a nuisance to nearby properties.
27. Amplified sound equipment shall be governed by a sound limiting device set at a level approved by Environmental Health.
28. No adult entrainment (paid for by the company of a nude nature) is permitted at these premises.
29. All children under the age of 16 years are to be accompanied on the premises by a responsible adult.
30. After 23:00 all performers shall be at least 18 years of age or over.
31. Records of identity and address, passports and, where applicable, work permits of all performers performing after 23:00 shall be held by the licensee and produced to the licensing authority or the police upon request.
32. No performance of mujra or similar kind will be offered.
33. The performances shall not be advertised, or in any way publicised, as mujra.
32. There shall be no physical contact between members of the audience and the performers.
33. The licensee shall ensure that no money shall be paid by any member of the audience or other customer at the premises, to any performer(s), whether directly, or to the licensee or any member of staff, for the performers.  
Notices to this effect shall be placed throughout the premises.
34. Should any S.34 AWP machines be present on the premises, they must either be emptied nightly or fitted with an appropriate recommended security device
35. A 'Challenge 21' scheme will be operated at the premises, whereby any person attempting to purchase alcohol or other age restricted product and who appears to be under the age of 21 years will be asked to provide proof (i.e. passport, driving licence or some other such accredited form of photo identification) that they are over 18 years of age: notices will be displayed advising that such a scheme is in operation; a record of age related refusals will be kept and made available to officers of the police and local authority upon request.
36. No drinking vessels are permitted to be taken outside the premises.
37. No entry or re-entry to the premises shall be permitted after 00:00 (midnight) from Sunday to Thursday, or after 00:30 on Fridays and Saturdays.

**Annex 3 - Conditions attached after a hearing by the licensing authority**

N/A

Annex 4 – Plan

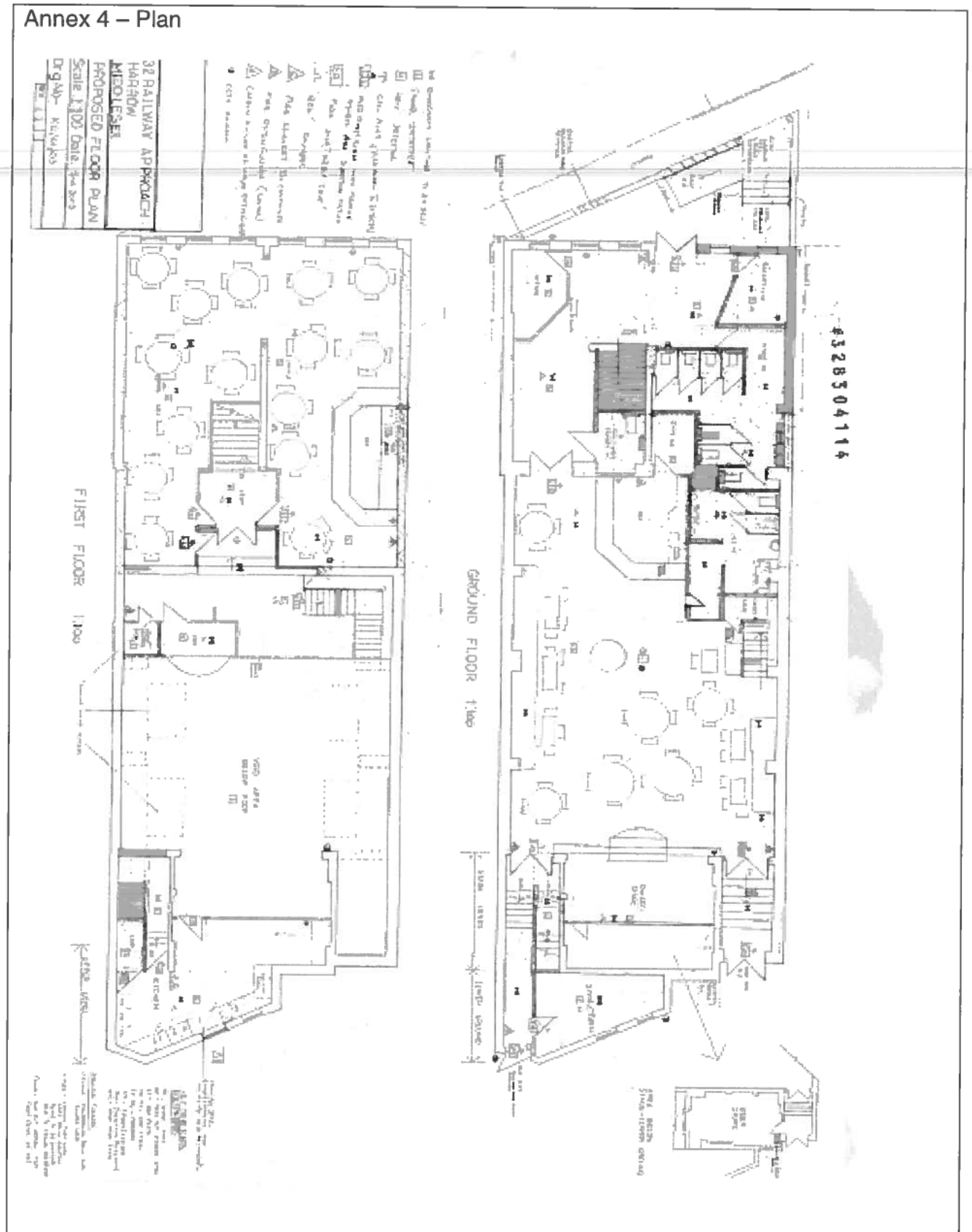

Date of original grant: 3/11/2010	Reason for issue: Minor Variation
Date of issue: 13th September 2011	Issue Number: 2